

CONSTRUCTION BLOCK WITH SHACKLE

1 SHEAVE

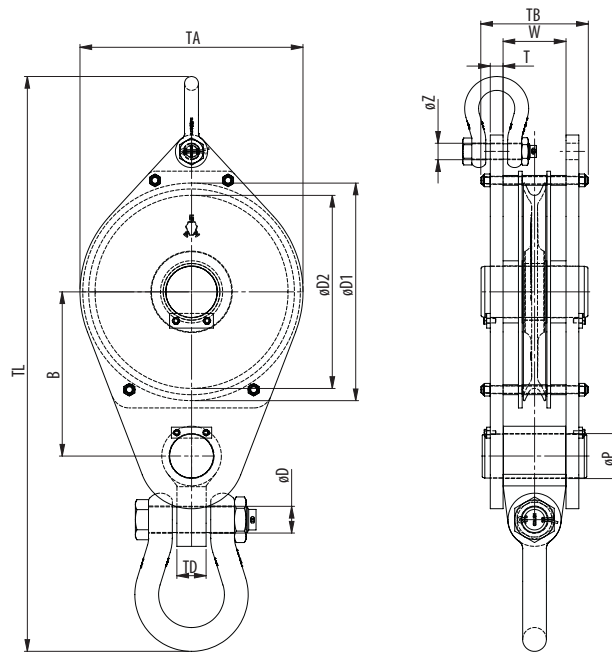

Model No.	WLL (Mtons)	For wire ød (mm)	Dimensions (mm)												Weight (kg)
			øD1	øD2	B	øD	øP	TD	øZ	T	TA	TB	TL	W	
CB 260.16.1.18,5	18,5	13-16	300	260	258	45	60	35	28	20	310	190	898	106	75
CB 320.19.1.27,5	27,5	16-19	365	320	297	53	70	45	31	25	375	214	1046	120	127
CB 355.22.1.36,5	36,5	19-22	410	355	339	60	100	60	41	30	420	252	1226	148	205
CB 400.26.1.45	45	19-26	460	400	368	68	100	65	41	30	470	260	1332	148	257
CB 450.28.1.55	55	22-28	515	450	409	73	120	80	45	35	530	294	1492	172	379
CB 528.32.1.64	64	22-32	595	528	449	73	120	80	45	35	610	294	1572	172	458
CB 575.36.1.73	73	26-36	650	575	494	86	140	110	53	40	670	339	1809	198	651
CB 630.38.1.82	82	26-38	710	630	524	86	140	110	53	40	730	339	1869	198	709

Minimum Ultimate Strength = 4 x WLL

- Standard delivered with bronze bearing
- The dimensions in this table are indicative only. A drawing will always be submitted prior production and will be the leading document when discussing dimensions.
- Blocks shown here are standard models; inquiries for custom versions are welcome.
- Refer to wire rope manufacturers D/d ratio guideline.



SEE OUR WARNING & SAFETY INFORMATION

Optional

With hanger

With pin

With swivel eye

With swivel jaw

